



Saracen Distribution
Unit 9, Grandstand Business Centre
Faraday Road, Hereford, HR4 9NS
Tel No: 01432 344133
Fax No: 01432 34412
Mobile: 07836 756468
info@saracendistribution.co.uk
http://www.saracendistribution.co.uk

ELAN AUTOMATIC WHEEL BALANCER

SBM 250



KEY FEATURES

- Tecalemit Aludata automated wheel weight positioning system
- Multi-operator programme allows different operators to use the machine without wasting time re-setting
- Option of pneumatic clamping
- Equipped with automatic measuring system for wheel data, speeding up the balancing procedure
- Fitted with position brake & wheel guard as standard
- Easy to use hidden (split) weight programme
- Suitable for balancing all types of aluminium alloy wheels
- Fitted with PAX wheel programme
- Suitable for higher volume garages & tyre shops
- Increased tool & weight storage space on cabinet

WHEEL BALANCING EQUIPMENT



SBM 250

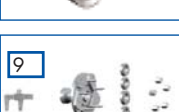
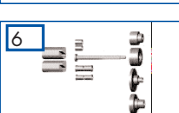
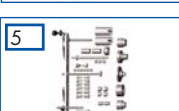
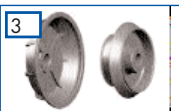

INSTALLATION & APPLICATION

The SBM 250 wheel balancer range from Tecalemit is a fully automated wheel balancer with LED digital display. The SBM 250 has been developed for use in facilities where total accuracy is a requirement particularly for aluminium alloy wheels.

The ALUDATA system locks the wheel into the correct position for application of the adhesive weight and the weight carrier arm positions automatically into the correct plane to ensure totally accurate application of the wheel weight. Data entry is via 2 measuring arms which automatically store the wheel dimensions ensuring both rapid and highly accurate wheel balancing in both static and dynamic modes.

Tecalemit is now able to offer SBM 250 with pneumatic clamping system, (at additional cost) for faster wheel mounting to balancer shaft - see below for ordering details.

TECHNICAL SPECIFICATIONS & DIMENSIONS

Weight (SBM 250)	158Kg
Weight (SBM 250P)	164Kg
Single Phase	230V - 0.37Kw - 50/60Hz - 13amp
Wheel Weight (max)	70Kg
Balancing Speed (rpm)	190
Wheel Diameter (max)	900mm
Rim Width	1" - 20"
Rim Diameter	10" - 26"
Air supply	8 - 10 Bar (SBM 250P only)

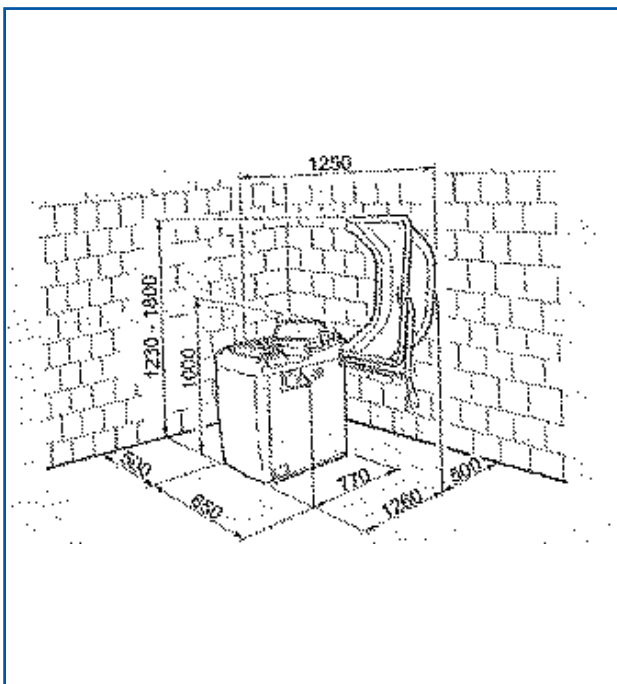

PART NO & ORDERING INFORMATION

Elan Automatic Wheel Balancer with ALUDATA system 1Ph SBM 250

Elan Automatic Wheel Balancer SBM 250 as SBM 250 with pneumatic Clamping (air supply required) SBM 250P

OPTIONS & ACCESSORIES

1. Intermediate Cone 89mm - 132mm (for off Road & Large wheels) OA 60057
2. Land Rover and Off - Road Flange Plate Kit OA 60147 includes OA 60057
3. Light Truck Cone & Spacer 20mm - 174mm(Includes OA 60057) OA 60036
4. Standard Motorcycle Adaptor Kit OA 60037
5. Professional Motor Cycle Adaptor Kit c/w monolever/scooter adaptors OA 60156
6. Scooter Adaptor Kit - to be used with OA 60037. OA 60061
Comprises of special adaptor for monolever X 2
7. Large Clamping Hood for Alloy Rims OA 60079
8. Adaptor for Transit Rims with 139mm centre hole OA 60086
(Year 2000 Ford Transit onwards)
9. Uni-Lug closed Centre Wheel Adaptor c/w set of centering rings. For use with certain Renault, Citroen, Peugeot & similar wheels. OA 60165
10. Metrocab and LTI Taxicab Adaptor with a centre hole of 130mm OA 60160
11. Wheel Balance Weight Starter Kit OA 60092
12. Wheel Weight Pliers SIC 606500
13. Rim Width Callipers SIC 602700
14. Teco Balancer Adapter Kit comprised of range of adapters with wall mounted storage unit OA 60240
15. Precision Balancing Kit OA 60277

SERVICE

Tecalemit have a team of over 50 service engineers covering the whole of the UK. On-site maintenance, testing, re-calibration and trouble-shooting can all be carried out with the minimum of fuss and downtime for customers. Please consult our Plymouth Service Centre for further information on 01752 219100.

WARRANTY

All products carry a 12 month warranty from the date of supply/installation, installation to be carried out by Tecalemit engineers. Exceptions to this being electrical cables and consumables.

SALES

Tecalemit Garage Equipment Co Ltd, Eagle Road, Langage Business Park, Plympton, Plymouth, Devon PL7 5JY

Tel: 00 44 (0) 1752 219111

