



Saracen Distribution
Unit 9, Grandstand Business Centre
Faraday Road, Hereford, HR4 9NS
Tel No: 01432 344133
Fax No: 01432 34412
Mobile: 07836 756468
info@saracendistribution.co.uk
http://www.saracendistribution.co.uk

ELAN AUTOMATIC WHEEL BALANCER WITH VIDEO DISPLAY

SBM V650



KEY FEATURES

- 17" Video display
- Easy menu operation
- Multi operator programme
- Single cycle static & dynamic balance
- Complete range of balancing programmes
- Foot operated shaft brake
- Automatic measurement for wheel data
- Hidden weight programme

WHEEL BALANCING EQUIPMENT

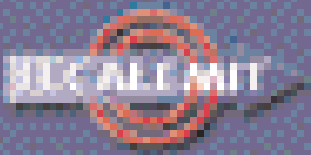

SBM V650

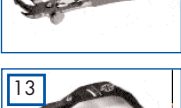
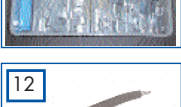
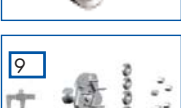
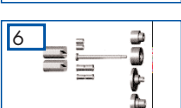
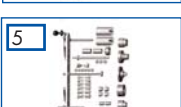
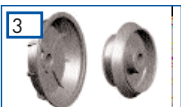

INSTALLATION & APPLICATION

The SBM V650 automatic wheel balancer from Tecalemit features high speed automated data entry via 2 measuring arms, which accurately calculate the wheel dimensions. The SBM 650 balancer has been developed for use specifically in high throughput garages, tyre shops and fast fits where speed and precision are a pre-requisite.

The SBM V650 has a large stable cabinet with ample storage space and 17" Video display, it also has a complete range of balancing programmes for Aluminium alloy wheels, pax & a hidden weight programme for spoked wheels.

Ease of use is enhanced by the high definition colour graphics which clearly display the weight position requirement.

The SBM V650 requires a 1Ph 240v power supply & must be installed on a flat, stable surface.

TECHNICAL SPECIFICATIONS & DIMENSIONS

Weight	158Kg
Single Phase	230V - 0.37Kw - 50/60Hz - 13amp
Wheel Weight (max)	65Kg
Balancing Speed (rpm)	167
Wheel Diameter (max)	900mm
Rim Width	1" - 20"
Rim Diameter	10" - 26"

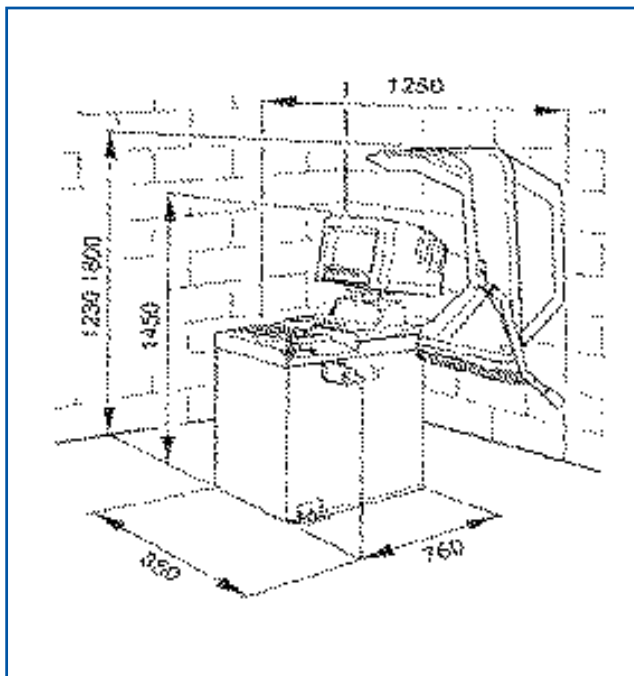

PART NO & ORDERING INFORMATION

Elan Automatic Wheel Balancer, 1Ph with Video Display

SBM V650

OPTIONS & ACCESSORIES

1. Intermediate Cone 89mm - 132mm (for off Road & large wheels)	OA 60057
2. Land Rover and Off-Road Flange Plate Kit	OA 60147
includes OA 60057	
3. Light Truck Cone & Spacer 20mm - 174mm (Includes OA 60057)	OA 60036
4. Standard Motorcycle Adaptor Kit	OA 60037
5. Professional Motor Cycle Adaptor Kit c/w monolever/scooter adaptors	OA 60156
6. Scooter Adaptor Kit - to be used with OA 60037.	OA 60061
Comprises of special adaptor for monolever X 2	
7. Large Clamping Hood for Alloy Rims	OA 60079
8. Adaptor for Transit Rims with 139mm centre hole (Year 2000 Ford Transit onwards)	OA 60086
9. Uni-Lug closed Centre Wheel Adaptor c/w set of centering rings. For use with certain Renault, Citroen, Peugeot & similar wheels.	OA 60165
10. Metrocab and LTI Taxicab Adaptor with a centre hole of 130mm	OA 60160
11. Wheel Balance Weight Starter Kit	OA 60092
12. Wheel Weight Pliers	SIC 606500
13. Rim Width Callipers	SIC 602700
14. Teco Balancer Adapter Kit comprised of range of adapters with wall mounted storage unit	OA 60240
15. Precision Balancing Kit	OA 60277

SERVICE

Tecalemit have a team of over 50 service engineers covering the whole of the UK. On-site maintenance, testing, re-calibration and trouble-shooting can all be carried out with the minimum of fuss and downtime for customers. Please consult our Plymouth Service Centre for further information on 01752 219100.

WARRANTY

All products carry a 12 month warranty from the date of supply/installation, installation to be carried out by Tecalemit engineers. Exceptions to this being electrical cables and consumables.

SALES

Tecalemit Garage Equipment Co Ltd, Eagle Road, Langage Business Park, Plympton, Plymouth, Devon PL7 5JY

Tel: 00 44 (0) 1752 219111
 Fax: 00 44 (0) 1752 219128
 Email: sales@tecalemite.co.uk
 Web: www.tecalemite.co.uk

